

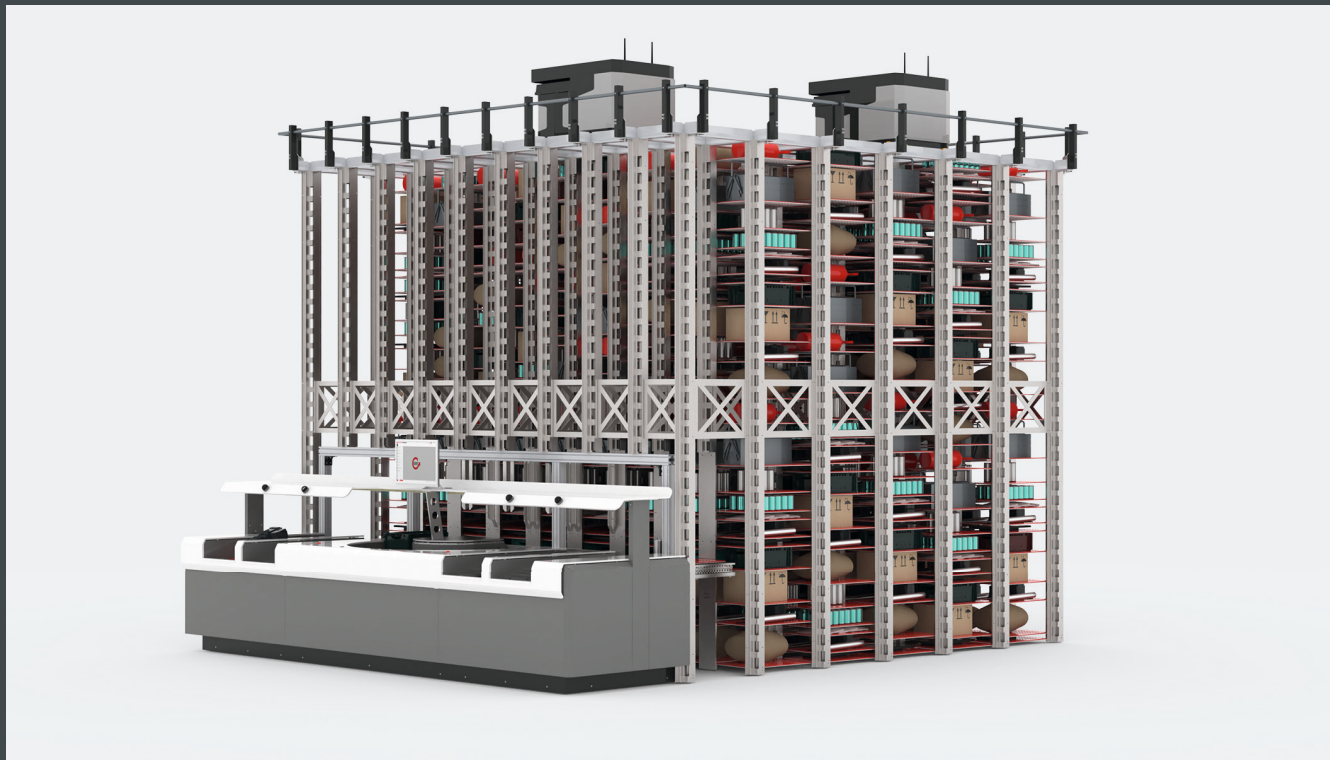

GEBHARDT Versastore®

Innovation for the Smart Factory



The GEBHARDT Versastore® is an innovative solution that transforms traditional storage methods of unit loads, semi-finished products, and other workpieces. Unlike conventional systems with fixed storage heights, the Versastore® adjusts dynamically to match the height of each specific load. This flexible adjustment maximises available space and allows for particularly compact and space-efficient storage. The shelves are organised in a high-density, block-storage-like structure, enabling direct access to workstations located within the warehouse or production area. The Versastore® bots can easily operate trays from above, providing greater flexibility. This adaptability opens up a wide range of potential applications and enhances efficiency in both the warehouse and connected production and conveyor systems.

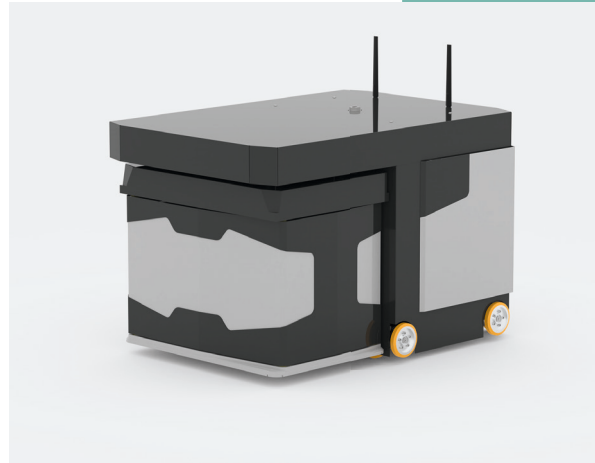

DIRECT PROCESSING OF WORKPIECES – MORE EFFICIENCY IN THE PRODUCTION PROCESS

What distinguishes the GEBHARDT Versastore® from conventional solutions is its unique ability to process workpieces directly on the tray. This feature saves valuable time and ensures that the workpieces remain securely positioned on the tray. This especially benefits automated production processes, where precision and continuous workflow are essential. In contrast to traditional systems, which often require repositioning, the Versastore® eliminates this step. This not only simplifies handling but also reduces production times.



OPTIMAL SOLUTIONS FOR DEMANDING INDUSTRIES

The GEBHARDT Versastore® is specifically designed for companies in challenging industries. These industries often face the dual challenge of automating production processes while efficiently managing the storage and transport of workpieces. The GEBHARDT Versastore® offers a solution that integrates these needs, optimising the entire process chain from the warehouse to production. As a result, Versastore® supports flexible and scalable production concepts suitable for batch sizes of one.



TECHNICAL EXCELLENCE FOR MAXIMUM EFFICIENCY

The GEBHARDT Versastore® stands out for its flexibility, versatility, and impressive technical performance. With speeds of up to 3.1 m/s and a high throughput rate, this system is perfectly designed for fast-moving automated processes. Its modular design allows for customisation to meet a company's specific needs.

With a maximum load capacity of 50 kg per tray and the capability to store items measuring up to 550 x 350 x 400 mm, the GEBHARDT Versastore® also addresses the highest demands for flexibility and functionality. The system's integration with automated guided vehicle systems (AGVs) and its direct connection to production systems significantly enhance the overall workflow.

The GEBHARDT Versastore® is managed by advanced Warehouse Execution Software (WES), which effectively oversees all logistics units. It features standardised interfaces that allow easy integration with warehouse management systems (WMS) and manufacturing execution systems (MES), ensuring compatibility with existing IT infrastructures. Artificial intelligence optimises transport routes to minimise travel distances and enhance material flow. Additionally, the software fine-tunes the height grid to maximise storage density and efficiently use available space.

VERSATILE APPLICATIONS IN STORAGE AND PRODUCTION

The GEBHARDT Versastore® system offers a diverse range of applications that extend beyond traditional storage methods. It is especially beneficial in production lines, where seamless integration between storage and processing is essential. Workpieces can be placed directly on the trays and undergo automated processing without the need for additional repositioning. This direct link to production systems enhances efficiency and minimises unnecessary steps in the workflow.

Another significant advantage of the Versastore® system is its high degree of flexibility in storing and processing workpieces. The trays can be adapted to suit various loads, allowing workpieces to be positioned accurately and securely. This precision is crucial for industries that depend on meticulous manufacturing processes. Furthermore, the efficient use of available space greatly reduces the overall space requirements.

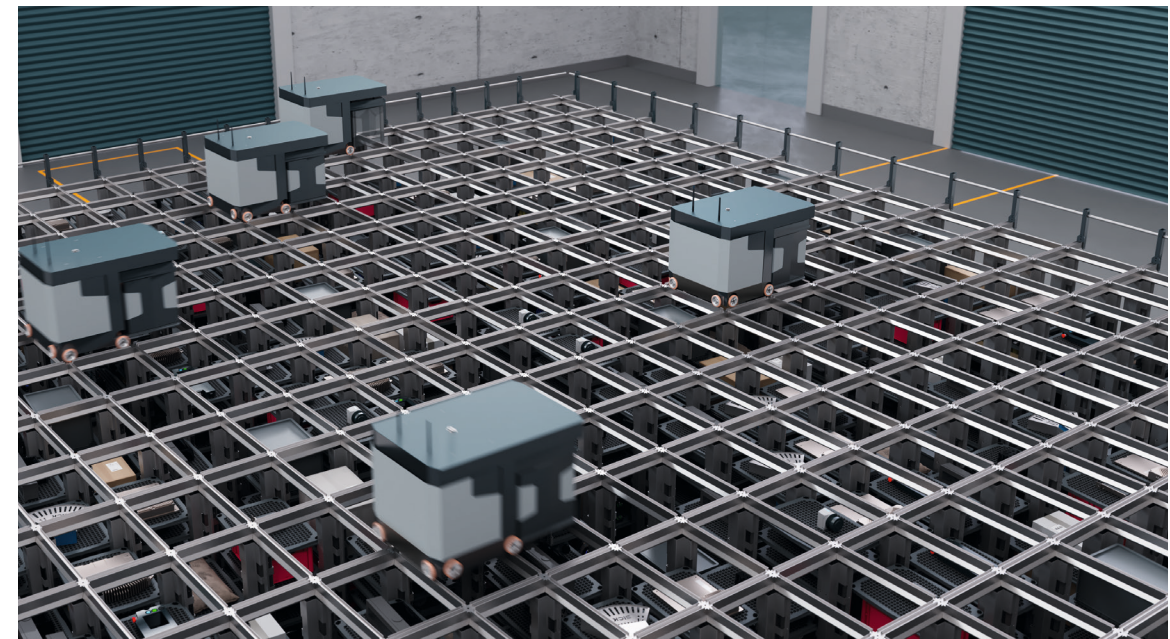

SHORT AND COMPACT: THE ADVANTAGES OF GEBHARDT VERSASTORE® AT A GLANCE

- Space-saving storage thanks to high-density block-like structure
- Flexible adjustment of the storage height to the load
- Direct operation from above by specialised vehicles
- Direct processing of workpieces on the tray without reloading
- Seamless integration into production processes and conveyor technology
- High speed (up to 3.1 m/s) and throughput capacity
- Modular design for individual adaptation
- Future-oriented and Industry 4.0-compatible

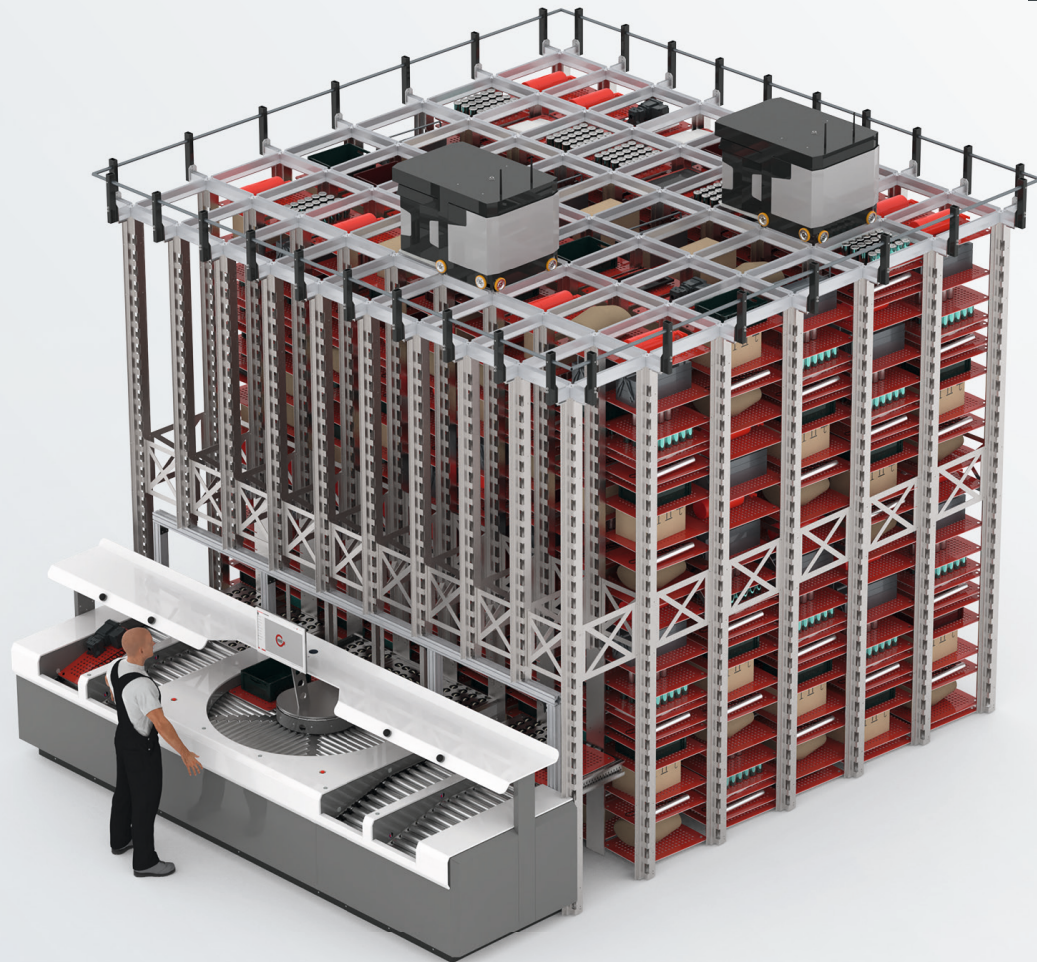

Speed of up to

3,1 m/s

Payload of up to

50 kg

Workpiece size up to

**550 x 350 x
400 mm**

Space utilisation up to

10 m



FUTURE-FOCUSED SOLUTIONS FOR YOUR PRODUCTION

The GEBHARDT Versastore® is not just a current solution; it represents a system that paves the way for the future. It meets the standards of Industry 4.0 and provides companies with significant advantages in efficiency, flexibility, and space optimisation. By connecting directly to production facilities and assembly workstations, along with the option for automation, the system saves time, reduces workload, and lowers production costs. These benefits contribute to a sustainable competitive advantage and a consistent increase in productivity.



Learn more at
[gebhardt.com](https://www.gebhardt.com)

NEXT GENERATION INTRALOGISTICS

Already in its third generation, the name GEBHARDT is closely associated with innovative intralogistics solutions. The company has always developed, manufactured and installed individual products as well as complete turnkey solutions. The portfolio includes storage systems, conveyor systems, sorting and order picking systems as well as goods lifts, automated guided vehicles and software applications.

The complete range of solutions, intelligent software and life-cycle services enables the most reliable and efficient automation technology for retail & e-commerce, food & beverages, automotive, healthcare, contract logistics, fashion & consumer goods and industry.



GEBHARDT Intralogistics Group
Neulandstr. 28 | 74889 Sinsheim
T +49 7261 939-0
info@gebhardt-group.com
www.gebhardt.com