

# Y-CIRC P-T-SERIES THE WATERPROOF PUSH-PULL-CONNECTOR

## 100% MADE IN GERMANY

Development and qualification in Munich with production in Frankfurt/Oder ensures rapid reaction to individual customer requirements. Our integrated manufacturing enables the highest quality coupled with short delivery times.

## BEST QUALITY

The Y-Circ P is made from **high quality materials** such as chrome-plated brass, peek, gold-plated contacts, etc. and is pluggable to existing systems.

## OPTIMISED COLLET HALF-SHELL SYSTEM

- Patented one-piece collet
- Power decoupling of collets to shells/insulation insert
- Easier assembly through identical half-shells

## ROBUST & COMPACT

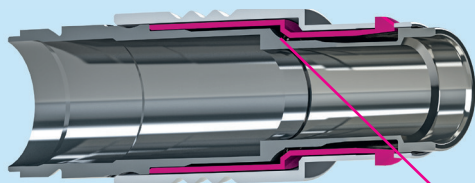

Long, innovative locking hooks guarantee the best possible locking in small installation space and up to 5,000 mating cycles.



## EASY, SAFE, FAST

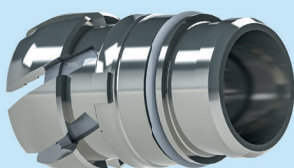

The patented one-piece collet enables simple, safe and fast assembly with high density.

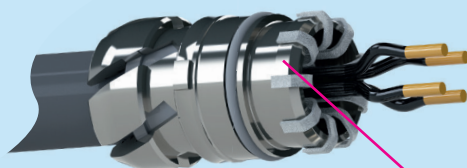

Large tolerance for cutting the braid for a perfect installation.



## STABLE CONNECTION

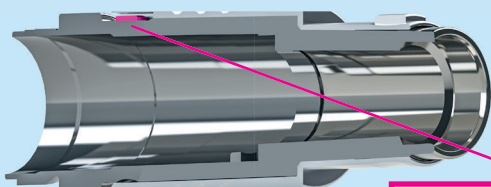

The outer and inner housing are coded to each other for higher precision and better absorption of torsional forces.



ENCLOSURE

INSULATOR

IDENTICAL  
HALF-SHELLS

COLLET

BACKNUT

BENT RELIEF

MADE  
IN  
GERMANY