

GEBR. RUBERG

Maschinenfabrik

POWERFUL AND
CONTINUOUS AT HIGH
THROUGHPUT AND EXCELLENT
MIXING QUALITIES



RUBERG *Throughfeed Mixer*
Series DLM

RUBERG Throughfeed Mixer Series DLM

Machine sizes:

From 0,5 to 750 m³/h throughfeed performance with a mixer chamber volume of 70 to 7.200 litres. In corresponding high-quality stainless or special steels. Individually adjustable mixer tools make possible a variable residence time of the product in the mixer chamber. Installation horizontal or at a pitch of up to 45°. Low operating costs by robust construction. Control flaps over the whole mixing length for cleaning and maintenance. Emptying efficiency > 98% depending on the design and mixer tools.



Type DLM 1000-3000
Stainless steel 1.4571.
For fertilizers.

Loosening
Homogenizing
Agglomerating
Moistening
Conditioning
Liquefying
Gluing
Deagglomerating
Greasing
Granulating
Dispersing
Neutralizing
Molassing
Emulsifying
Dissolving
Coating

Operation:

In the inlet area the continuously fed product is taken up and transported by the first mixer tools. Alternating compressing and expanding working ranges homogenize the mixture. On the basis of the adjustable angles for the mixer tools and the circumferential speed adjusted to the mixture the residence time of the product in the mixer chamber can be varied. The frequent contact of the product with the mixer tools and the speed adjusted to the mixture cause e.g. powders and liquids to agglomerate. The fully developed technology and robust design guarantee faultfree operation with a long service life.

Variants depending on the process technology:

- Protection against wearing by cast basalt lining
- Product encrusting prevented by wear-resistant nonstick lining of the mixer chamber
- Facility for the addition of liquids, vapours, gases and highly viscous media into various operation zones of the mixer tools
- Continuous throughfeed weighing, with an impact scale, for determining the throughfeed performance as well as for the fully automatic metering of further additives
- Process monitoring via integrated sensors (power, temperature, moisture, etc.)

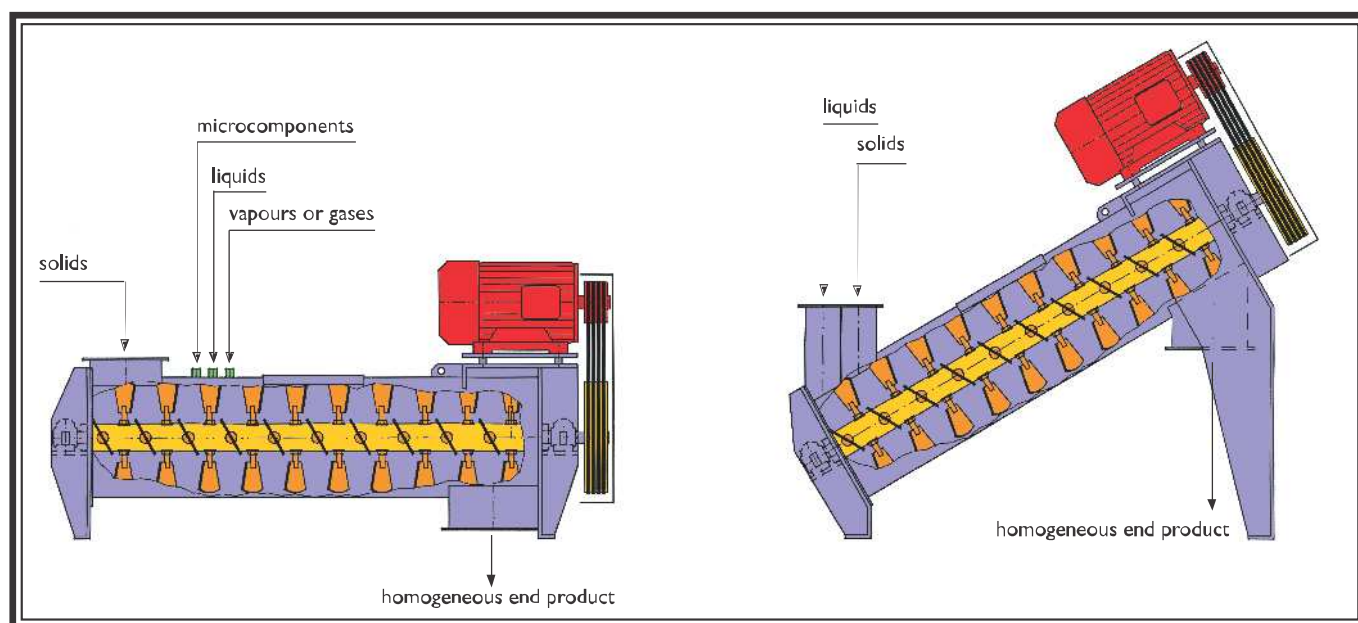

RUBERG Throughfeed Mixer

Series DLM - Dimension Sheet

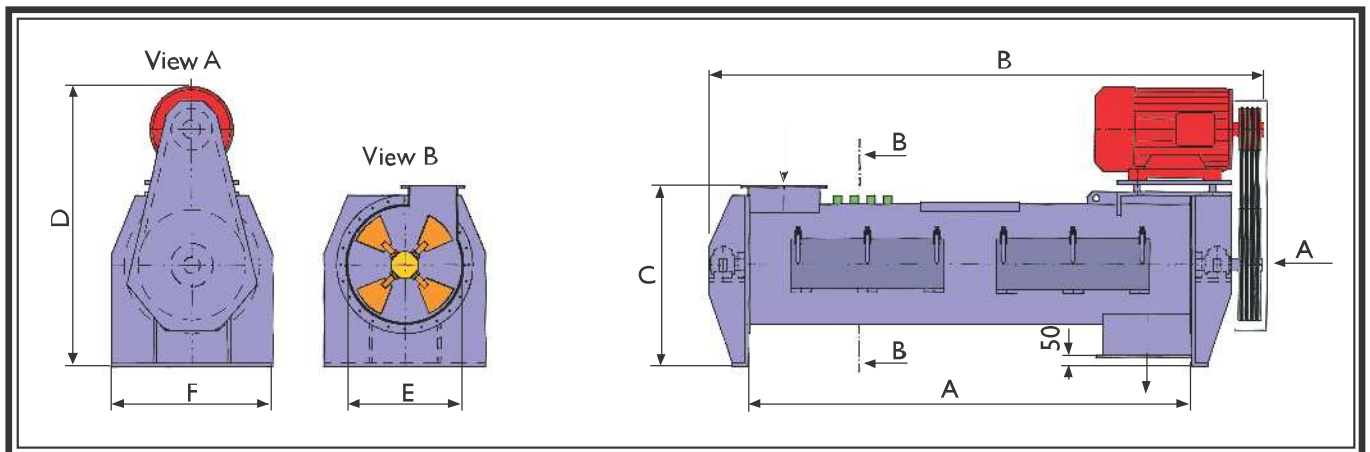

Type	Mixer chamber volume in litres	Throughput performances in m ³ /h	Drive ratings in KW	Approx. dimensions					
				A in mm	B in mm	C in mm	D in mm	E in mm	F in mm
DLM 250-1500	70	0,5- 10	2,2- 11,0	1500	2400	425	425	250	340
DLM 350-1500	140	1,5- 20	3,0- 15,0	1500	2450	475	475	350	440
DLM 350-2000	190	5- 50	5,5- 30,0	2000	2500	675	1100	350	500
DLM 500-2500	480	50- 80	15,0- 45,0	2500	3040	800	1350	500	690
DLM 600-2500	700	80-120	30,0- 75,0	2500	3100	950	1650	600	790
DLM 800-3000	1500	120-200	45,0-110,0	3000	3750	1150	1900	800	990
DLM 1000-3000	2100	200-400	75,0-200,0	3000	3850	1450	2400	1000	1200
DLM 1000-4000	2800	200-400	75,0-250,0	4000	4950	1450	2475	1000	1200
DLM 1200-4000	4250	300-750	110,0-315,0	4000	4950	1550	2700	1200	1400
DLM 1250-6000	7200	300-750	110,0-360,0	6000	8750	1750	2800	1250	1500

RUBERG Throughfeed Mixers of all sizes can be made for individual requirements. Likewise, the inlets and outlets as well as the arrangement of the inspection doors can be freely selected.

Type DLM 500-2500

Stainless steel 1.4571.

With weir plate, insulated heating jacket and heated exhaust duct for coating of chemical granulates.



Type DLM 250-1500

Stainless steel 1.4571.

With insulated heating jacket for chemical powders.

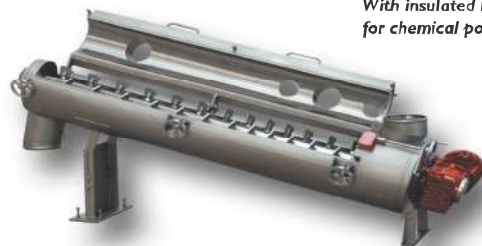

Type DLM 800-3000

Stainless steel 1.4301.

For animal feed.



Type DLM 350-1500

Stainless steel 1.4571.

With barrier air purging for foodstuffs.





Modern Testing Centre

RUBERG Throughfeed Mixer DLM 600-2500

With connected dosing equipment for organic insulating material.



As a factory for machinery, the company Gebr. Ruberg GmbH & Co. KG was founded as a family concern in 1848. From the then production of primarily wind- and watermills there arose through the decades a modern machinery production facility. Our machines are used for chemicals, foodstuffs, pharmaceuticals, construction and plastic materials and our production programme extends over the complete planning, production and installation of complete plants and individual machines. A specialized staff of about fifty members have made innovation and progress our business. The tests and trials conducted in our testing centre allow us to develop systems and machines to the most advanced level of technology and standards.

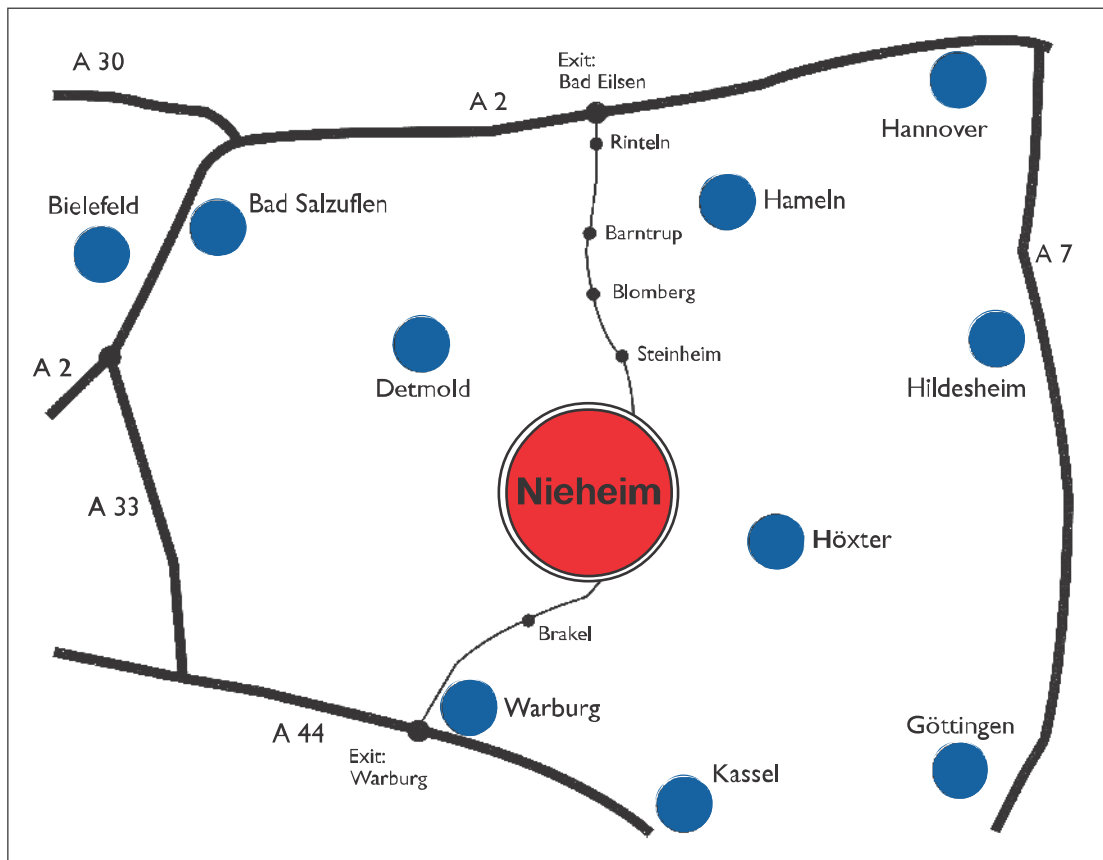

GEBR. RUBERG
Maschinenfabrik

Gebr. Ruberg GmbH & Co. KG
P.O.B. 1149 · D-33035 Nieheim
Christian-Ruberg-Straße · D-33039 Nieheim
Phone +49 (0)5274 - 98510-0 · Fax +49 (0)5274 - 98510-50
www.g-ruberg.com
eMail: info@g-ruberg.com