



## FEATURES

- 13.3" IPS LCD Display (1920 x 1080 Resolution)
- Intel® Tiger Lake i5-1135G7 Processor with Fanless Design
- Intel® Iris® Xe Graphics
- Windows 11 Pro 64bit or Windows 11 IoT
- Built-in Windows Hello Facial Recognition
- Versatile 180° Rotatable Kickstand that can be Served as a handle
- Customizable Medical Imaging I/O Port for X-ray, Ultra-sound, Endoscope
- 66.3Wh High-capacity Battery
- IP54 Water & Dust Protection
- Capacitive 10-Point Multi-Touch: Support Glove and Wet Touch

The 13.3" Medical Tablet PC features a Full HD IPS LCD screen (1920 x 1080) for crystal-clear visuals, powered by a fanless Intel® Tiger Lake i5-1135G7 processor and Intel graphics, delivering smooth and efficient performance. Available with either Windows 11 Pro or IoT, this device provides flexibility for various healthcare applications. Its versatile 180° rotatable kickstand doubles as a handle, enhancing mobility and ease of use, while customizable I/O options enhance connectivity to medical imaging sensors, such as X-rays, ultrasounds, and endoscopes. Built for durability, the tablet offers IP54-rated protection against water and dust, a 6-hour battery life, and a responsive 10-point capacitive touchscreen that supports both glove and wet touch, making it ideal for dynamic healthcare environments.

## SPECIFICATIONS

### RUGGEDNESS

IP Rating	IP54 Water & Dust Protection
-----------	------------------------------

### SYSTEM

Processor	Intel Tiger Lake i5-1135G7, Max Turbo Frequency 4.2GHz, 8 MB Intel® Smart Cache
GPU	Intel® Iris® Xe Graphics
Memory	16GB LPDDR4
Storage	NVMe Gen 4 256GB SSD <b>Optional:</b> 512GB / 1TB
OS	Windows 11 Pro 64bit or IoT

### DISPLAY

Screen Size	13.3" IPS LCD
Resolution	1920 x 1080
Brightness	400 nits Backlight
Touch Screen	Capacitive 10-Point Multi-Touch

### COMMUNICATIONS

Ethernet	1 x RJ45 10/100/1000M Port
Wi-Fi	Intel® Wi-Fi 6E AX210 (Support 2.4G & 5G)
Bluetooth	Bluetooth 5.2

### POWER

AC Adapter	110-240V AC Input, 19V 3.15A DC Output, Standard US Plug Medical AC Adapter
Battery	11.4V, 5820mAh, 66.3Wh

### I/O INTERFACE

Audio	2 x Speaker, 8Ω/2W 2 x Microphone
Camera	Front Camera: 5MP for Windows Hello Rear Camera: 5MP with Auto Focus
Ports	1 x 3.5mm Audio Jack 1 x 5mm DC Jack 3 x USB 3.0 Type A Ports 1 x USB C Port (Support USB 3.1, Display, and Charging)
Buttons	Power On/Off Button 4 x Programmable Buttons

### MECHANICAL

Chassis	Front: Plastic + TPU, Rear: Aluminum Alloy CNC
Dimensions	339 x 235 x 37.5mm
Weight	About 2.4Kg
Kickstand	180-degree Rotatable Kickstand
Cooling	Fanless

### ENVIRONMENTAL

Temperature:	
- Operation	0°C to 40°C
- Storage	-20°C to 60°C
Humidity	10% to 90% Non-condensing

### REGULATORY

Certification	FCC, RoHS Compliant, IEC60601-1, IEC60601-1-2
---------------	---

## DIMENSIONS AND SYSTEM LAYOUT

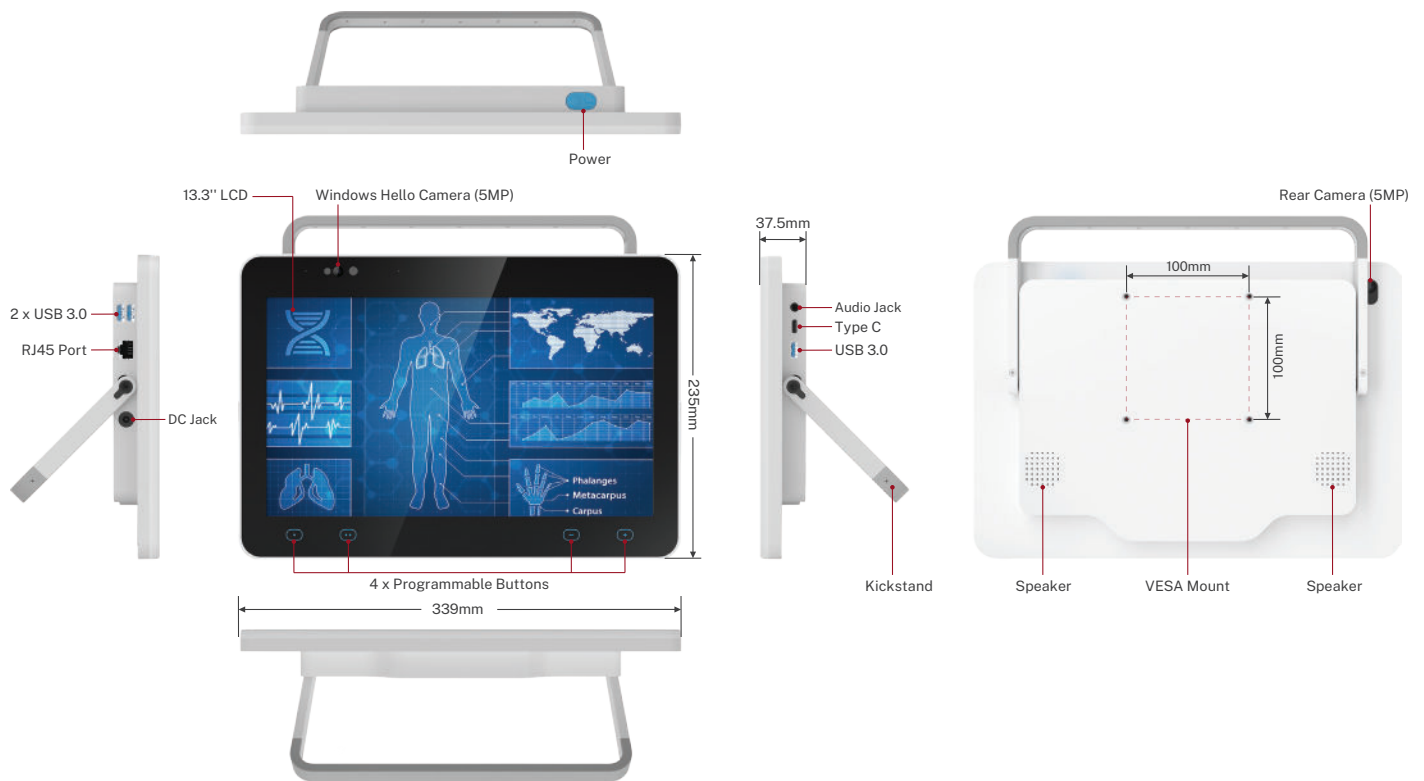

## MULTIPLE USE SCENARIOS

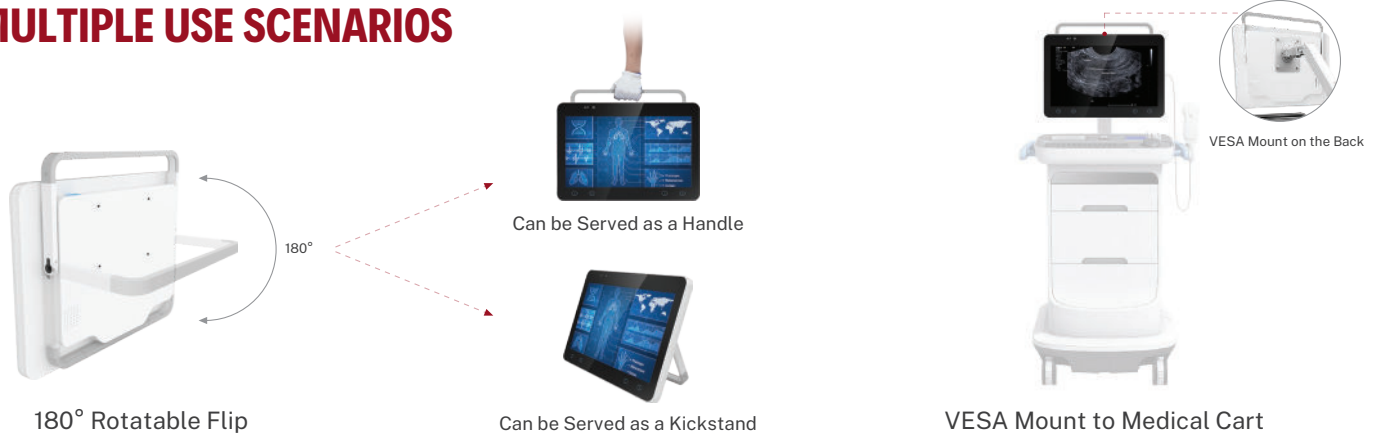

## MARKET AND APPLICATIONS

Electronic Medical Records (EMR) Management  
Medical Imaging and Diagnostics  
Telemedicine and Remote Consultations  
Clinical Decision Support Systems (CDSS)  
Mobile Medical Workstation for Healthcare Professionals  
Patient Monitoring and Documentation  
Pharmacy and Medication Management