



AVK REPICO® - GRIP PLAST COUPLING (GP)

745/11-111

Tensile / axial restraint, for all plastic pipes, stainless steel 316L, EPDM

AVK's Repico® product program consists of stainless steel pipe couplings and repair couplings for pipe diameters from DN15-2000. The Repico® range offers a quick and simple connection solution for all pipes with possibility of angular deflection and easy handling due to the compact and light weight design.

Product description:

Repico® GP - Grip Plast type coupling (tensile / axial restraint) to connect all plastic pipes. For water and neutral liquids -30°C up to +110° C

Test/Approvals:

Material approvals:

- EN 681-1
- EG (UBA)
- W270 (DVGW)
- BS 6920 (WRAS)
- XP P 41-250 (ACS)
- 21CFR 177.2600 (FDA)

Features:

- Grip Plast type coupling provides a tensile / axial restraint connection for all plastic pipes, allows pipe section replacement, suitable for high pressure, and is available in DN32-200
- Couplings < DN50 with spot welding and from DN50 seam welding
- Easy installation by use of a torque wrench, limited space required for installation due to compact design
- Specially designed flat rows of grips engages into the pipe surface without damaging the plastic material
- Pressure range up to 16 bar (232 PSI) depending on size
- Progressive sealing and anchoring
- Max. angular deflection 5° for DN32-50, 4° for DN65-175 and 2° for DN200 and larger
- Main components of stainless steel 316L
- Green PTFE coated bolts
- Light weight, appr. 30% in comparison with flanged connections
- Dampens water hammer, vibrations and structure-borne noise
- **Note:** For use in plastic pipes we recommend the use of a stainless steel insert (see mounting instructions of Repico® accessories)

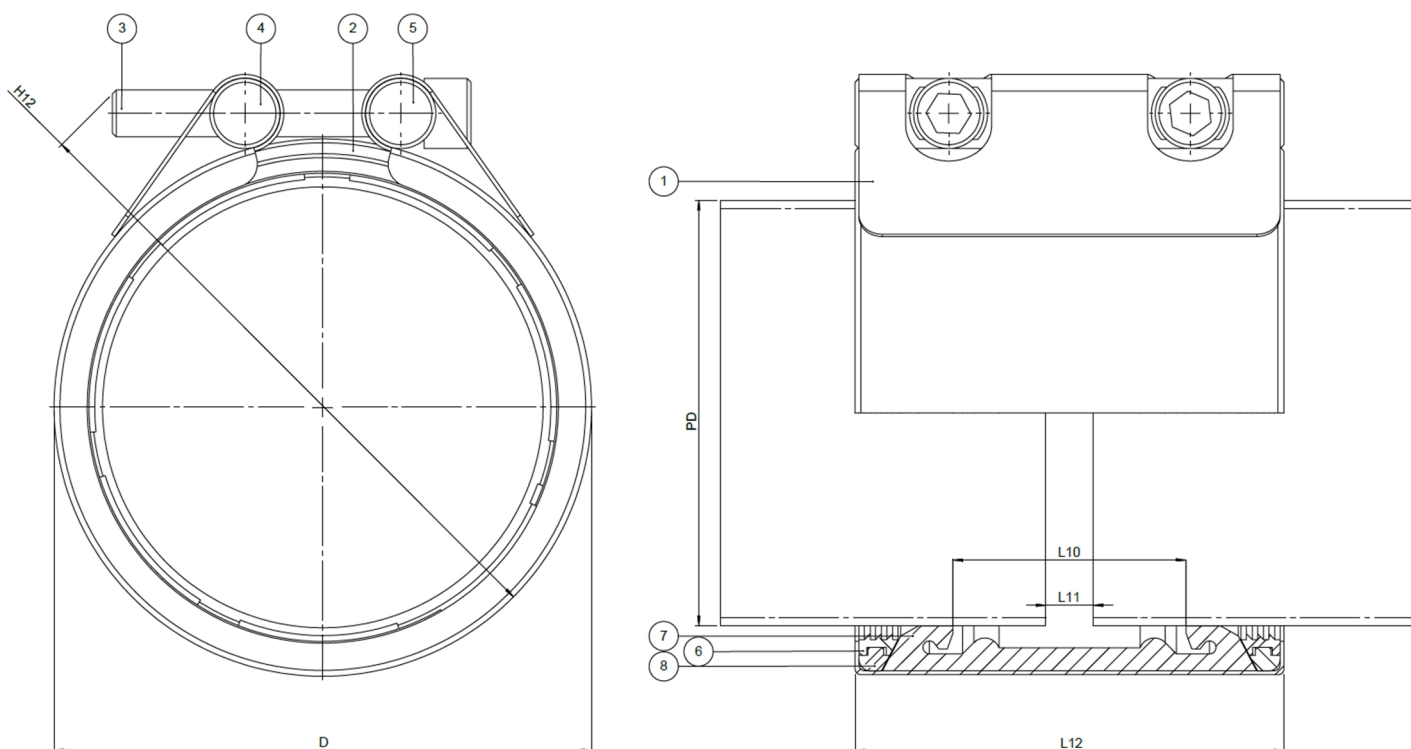

Expect... **AVK**

AVK REPICO® - GRIP PLAST COUPLING (GP)**745/11-111****Tensile / axial restraint, for all plastic pipes, stainless steel 316L, EPDM****Component list:**

1. Body	Stainless steel AISI 316L	5. Washer	Stainless steel AISI 316L
2. Side plate	Stainless steel AISI 316L	6. Grip segment	Stainless steel AISI 316L
3. Bolt	Stainless steel A4, PTFE coated	7. Sealing	EPDM rubber
4. Nut	Stainless steel AISI 316L	8. Support ring	TPU

Components may be substituted with equivalent or higher class materials without prior notification.

Reference nos. and dimensions:

AVK ref. no.	DN mm	Tolerance mm	Pipe diam. mm	Work press. bar	D mm	H12 mm	L10 mm	L11 mm	L12 mm	Bolt Size (Metric)	Theoretical weight/kg
745-11-0040-11111	32	39,5 - 41,5	40,0	16	53	77	28	8	60	2XM8X55	0.4
745-11-0050-11111	50	49,5 - 51,5	50,0	16	64	88	28	8	60	2XM8X55	0.4
745-11-0063-11111	50	62,4 - 63,6	63,0	16	79	101	44	8	80	2XM8X55	0.7
745-11-0075-11111	65	74,0 - 76,2	75,0	16	92	114	44	8	80	2XM8X55	0.8
745-11-0090-11111	80	87,8 - 91,0	90,0	16	109	137	59	15	110	2XM12X70	1.5
745-11-0110-11111	100	108,5 - 110,5	110,0	16	128	156	59	15	110	2XM12X70	1.6
745-11-0160-11111	150	157,5 - 161,0	160,0	16	179	211	59	15	111	2XM12X80	2.3
745-11-0200-11111	200	198,2 - 201,5	200,0	16	226	265	89	15	150	2XM14X100	4.6

The designs, materials and specifications shown are subject to change without notice due to the continuous development of our product range.