

GRIPPS®

H06055-100 GRIPPCLIP (100-PACK)

The innovative GrippClip, manufactured from 0.8mm stainless steel, is the quickest and most effective method of fixing down matting and other encapsulation products.

By simply pushing the GrippClip through the holes in the matting, and clipping it to the steel grating below, matting and encapsulation products will be secured. To remove, simply pull the matting or encapsulation product straight up, or insert a flat screwdriver under the GrippClip to lift it up.

This product is reusable and extremely durable.

**Designed for steel grating flooring applications only.*

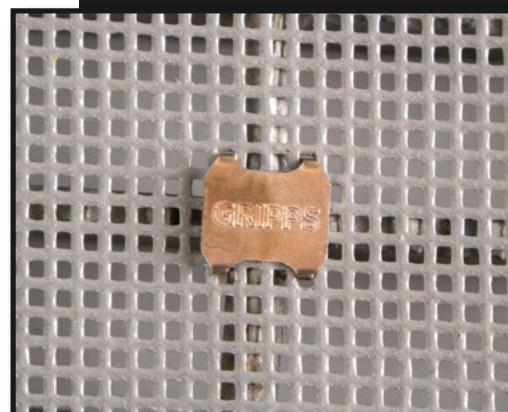

ENGINEERED FOR DROP PREVENTION

www.gripps.com

GRIPPS®

KEY FEATURES



SPECIFICATIONS

SKU	QTY	THICKNESS	CLIP DIMENSIONS
H06055-100	100 Pack	.8mm	17mm (L)x 17mm (W) x 15mm (H)
		.31in	.67in (L)x.67in (W) x.59in (H)

HOW TO USE

1

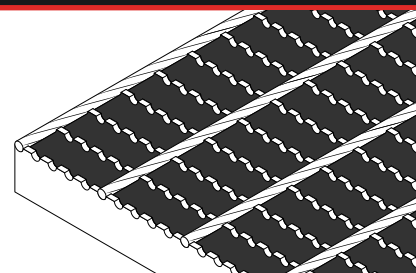

Ensure your flooring is steel grating type. Note the orientation of the "cross bars".

2

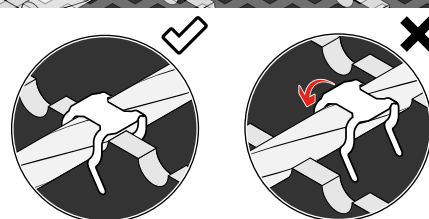
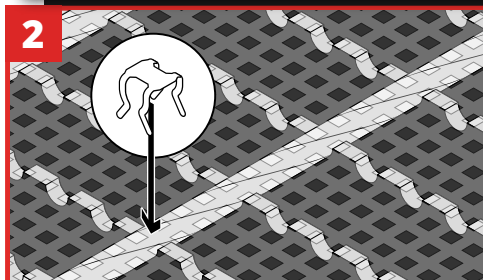

Lay down your GRIPPS® GrippGrid Matting flat. After, locate the intersection of the load and cross bars in the steel. Orientate the clip correctly so it will hold the cross bar.

3

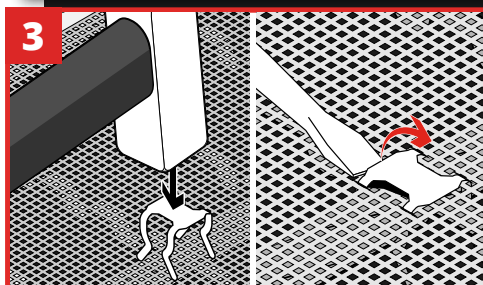

Push the clip through using a hammer. To remove clips, pry up with a flat tip screwdriver.

4

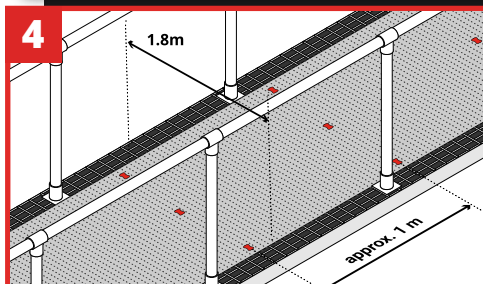

Apply clips approximately 1m/3ft apart. Use additional clips if required to ensure matting remains flat and to avoid trip hazards.