

www.tempLED.de

tempLED



OUTDOOR AND ROADWAY LIGHT

tempLED RayTrack Lite

75 | 150 | 240

Our customer
ESF Elbe-Stahlwerke Feralpi

OUTDOOR LIGHTING 

tempLED

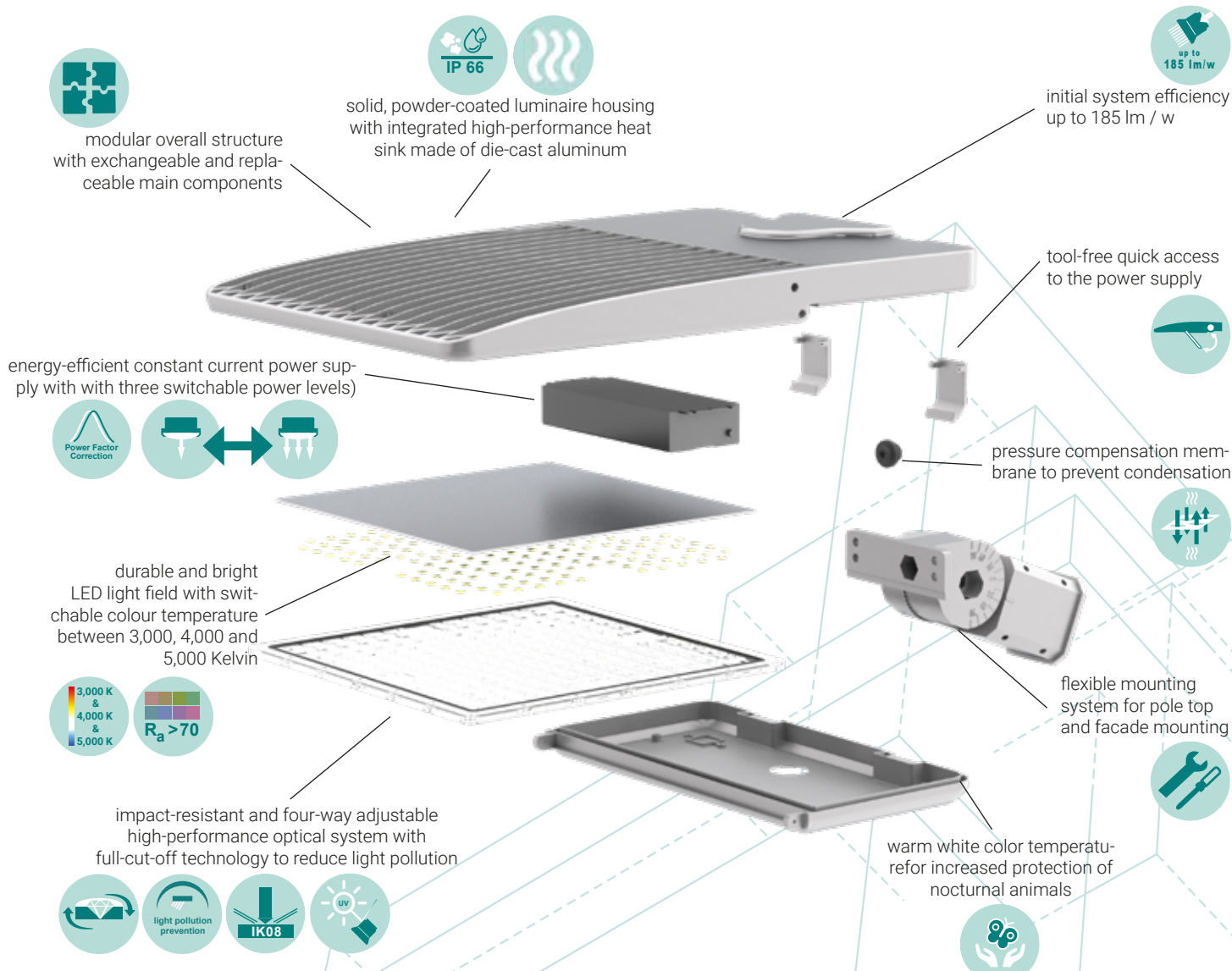

Light distribution curve tempLED RayTrack Lite 75 | 150 | 240

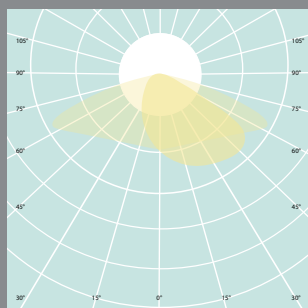

80x150 degrees asymmetrical full-cut-off technology

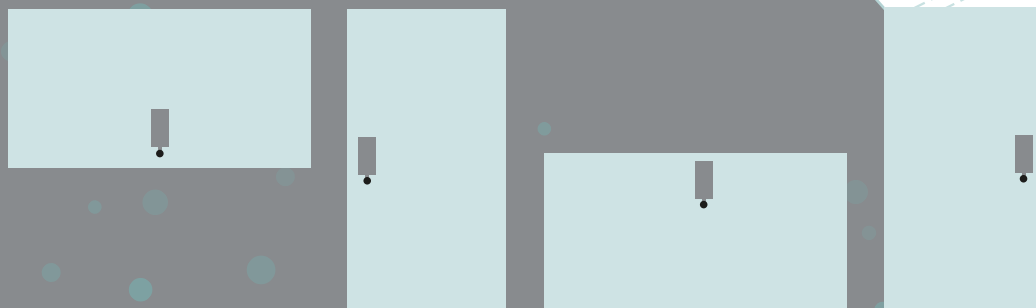

four-way adjustable high-performance optical system (position 0 (standard) | 90 | 180 | 270) the right illumination of the requested area for each mounting position

tempLED RayTrack Lite

Dimensions

75 | 150

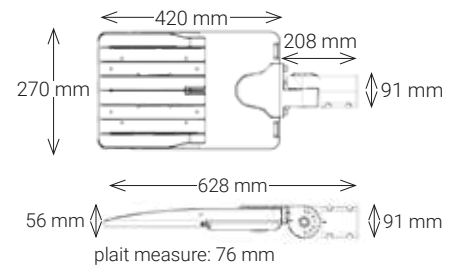

Windage area fw with luminaire
inclination angle 0 degrees: 0,02 m².

240

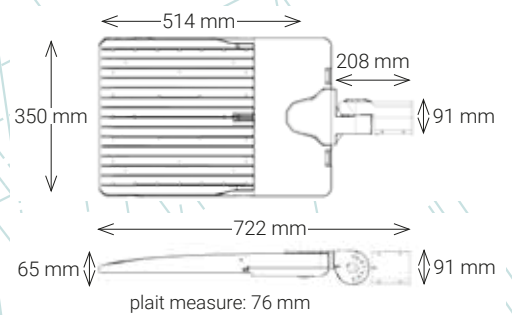

Windage area fw with luminaire
inclination angle 0 degrees: 0,03 m².

Mounting options tempLED RayTrack Lite

75 | 150 | 240

pole top mounting¹facade mounting²bracket mounting³

¹ Adjustment range for pole top mounting with included pole top: -90 to +90 degrees.

² Adjustment range for facade mounting with optional wall holder 932141: -90 to +90 degrees.

³ Adjustment range for surface mounting with optional mounting bracket 932142 / 932145 / 932146: -90 to +90 degrees.

General technical data

according to IEC, identical for all types of luminaires



Lighting properties:

| | |
|---|---|
| initial luminous flux: | up to 44,400 lumens |
| luminous flux tolerance: | ± 10 percent |
| initial system efficiency: | up to 185 lumens / watt |
| initial, most similar color temperature: | switchable between 3,000, 4,000 and 5,000 kelvins |
| initial color rendering index (CRI): | Ra > 70 |
| initial color consistency: | < 5 SDCM |
| available asymmetrical beam angles: | 80 x 150 degrees |
| individually adjustable high-performance optical system:: | yes, four ways |
| photobiological safety: | IEC/TR 62778: 1 |
| stray light reduction: | yes, with full-cut-off technology |
| increased protection of nocturnal animals: | yes, with color temperature 3,000 kelvins |
| compact flicker degree (CFD): | 1 percent |
| stroboscopic visuability measurement (SVM): | < 0.01 |
| short time flicker (Pst LM): | < 0.01 |

Electrotechnical properties:

| | |
|------------------------------------|---------------------|
| power supply AC: | 100 to 240 volts |
| supply frequency: | 50 / 60 hertz |
| power supply DC: | 127 to 250 volts |
| system performance: | 48 to 240 watts |
| system performance tolerance: | ± 10 percent |
| power factor: | > 0.95 |
| overvoltage protection: | yes |
| overheating protection: | yes |
| temperature monitoring: | yes |
| total harmonic distortion (THD): | < 20 percent |
| temperature classification (ATEX): | T5 |
| Tc - temperature: | +90 degrees Celsius |

Energetechnische Eigenschaften:

| | |
|---|--|
| Valid for all tempLED RayTrack Lite up to 169 lm/w: | This product contains a light source of energy efficiency class C. |
| Valid for all tempLED RayTrack Lite from 170 lm/w: | This product contains a light source of energy efficiency class B. |

Mounting options:

| | |
|----------------------------|---|
| standard mounting options: | pole top with adjustment range -90 to +90 degrees |
| optional mounting options: | wall holder with adjustment range -90 to +90 degrees mounting bracket with adjustment range -90 to +90 degrees |

Housing properties:

| | |
|---|--|
| ambient temperature: | –40 to +50 degrees Celsius |
| ingress protection: | IP 66 |
| impact resistance level: | IK08 |
| electrical protection class: | I |
| limited surface temperatur (D): | yes |
| pressure compensation membrane: | yes |
| housing and heat sink material(s): | die-cast aluminum |
| material and finish of the standard pole top: | die-cast aluminum, powder-coated in white aluminium according to RAL 9006 ¹ |
| material of optical system: | impact- and UV-resistant polycarbonate |
| luminaire housing color: | white aluminium according to RAL 9006 ¹ |
| surface finish: | powder coating ¹ |
| supply cable type: | H05RN-F 3G1 ² |
| supply cable length: | 30 centimeters ² |
| supply cable inlet: | cable gland |
| supply cable connection type: | open cable end |
| number of poles: | 3 grid ² |

Additional information:

| | |
|-----------------------|---|
| certificates: | ENEC in preparation |
| conformities: | CE and RoHS |
| lifespan (L70B10C1): | approx. 100,000 hours |
| lifespan (L90B10C1): | approx. 50,000 hours |
| guarantee: | 5 years ³ |
| spare part guarantee: | 10 years |
| delievery includes: | luminaire and pole top (spigot size: 76 mm) |

¹ optional luminaire housing colors and finishes: Paintings according to RAL colour chart, powder coatings according to RAL colour chart or synthetic resin coating.

² alternatively: direct cabling in the luminaire housing.

³ according to the warranty conditions of tempLED GmbH, excluding accessories.

Logistic information:

| | | |
|-----------------------------------|------------------------|--------------------|
| luminaire: | RayTrack Lite 75 150 | RayTrack Lite 240 |
| number of luminaires per package: | 1 | 1 |
| number of luminaires per pallet: | 39 | 39 |
| net weight of the luminaire: | 4,800 g | 7,000 g |
| gross weight per package: | 6,600 g | 8,700 g |
| package dimensions L x W x H: | 680 x 360 x 155 mm | 760 x 410 x 150 mm |



tempLED 75

RayTrack Lite 75 - 80x150 CCT

| | |
|---|--|
| article number: | 400001 |
| GTIN / EAN: | 4262493352257 |
| initial luminous flux at 3,000 K: | 7,968 / 9,960 / 12,450 lm |
| initial luminous flux at 4,000 K: | 8,880 / 11,100 / 13,875 lm |
| initial luminous flux at 5,000 K: | 8,400 / 10,500 / 13,125 lm |
| initial system efficiency at 3,000 / 4,000 / 5,000 K: | 166 / 185 / 175 lm/W |
| initial, most similar color temperature: | switchable between 3,000 / 4,000 / 5,000 K |
| light distribution: | asymmetrical |
| beam angle: | 80 x 150 degrees |
| dimming / control: | none |
| system performance: | switchable between 48 / 60 / 75 W |
| power consumption: | up to 0.33 A |
| maximum inrush current: | 65 A |
| dimensions (L x W x H): | 628 x 270 x 56 mm |



tempLED 150

RayTrack Lite 150 - 80x150 CCT

| | |
|---|--|
| article number: | 400002 |
| GTIN / EAN: | 4262493352264 |
| initial luminous flux at 3,000 K: | 16,600 / 19,920 / 24,900 lm |
| initial luminous flux at 4,000 K: | 18,500 / 22,200 / 27,750 lm |
| initial luminous flux at 5,000 K: | 17,500 / 21,000 / 26,250 lm |
| initial system efficiency at 3,000 / 4,000 / 5,000 K: | 166 / 185 / 175 lm/W |
| initial, most similar color temperature: | switchable between 3,000 / 4,000 / 5,000 K |
| light distribution: | asymmetrical |
| beam angle: | 80 x 150 degrees |
| dimming / control: | none |
| system performance: | switchable between 100 / 120 / 150 W |
| power consumption: | up to 0.66 A |
| maximum inrush current: | 147 A |
| dimensions (L x W x H): | 628 x 270 x 56 mm |



tempLED 240

RayTrack Lite 240 - 80x150 CCT

| | |
|---|--|
| article number: | 400003 |
| GTIN / EAN: | 4262493352271 |
| initial luminous flux at 3,000 K: | 29,880 / 33,200 / 39,840 lm |
| initial luminous flux at 4,000 K: | 33,300 / 37,000 / 44,400 lm |
| initial luminous flux at 5,000 K: | 31,500 / 35,000 / 42,000 lm |
| initial system efficiency at 3,000 / 4,000 / 5,000 K: | 166 / 185 / 175 lm/W |
| initial, most similar color temperature: | switchable between 3,000 / 4,000 / 5,000 K |
| light distribution: | asymmetrical |
| beam angle: | 80 x 150 degrees |
| dimming / control: | none |
| system performance: | switchable between 180 / 200 / 240 W |
| power consumption: | up to 1.05 A |
| maximum inrush current: | 73.5 A |
| dimensions (L x W x H): | 722 x 350 x 56 mm |

| tempLED | Accessory catalogue RayTrack Lite | art.-no. | GTIN / EAN |
|---|---|----------|---------------|
|  | pole top system for pole-top mounting of the tempLED RayTrack Lite on poles with a spigot size of 76 mm, adjustment range: -90 to +90 degrees, material: die-cast aluminium, finish: powder coating in white aluminium according to RAL 9006, included in delivery of all tempLED RayTrack Lite | 401907 | 4262493352301 |
|  | reducer ring for use with the pole top system 401907, to reduce the spigot size from 76 to 60 mm, material: die-cast aluminium, finish: powder coating in white aluminium similar to RAL 9006 | 401902 | 4262493352318 |
|  | wall holder for mounting the tempLED RayTrack Lite on walls and façades, two-part with integrated cabling compartment, adjustment range: -90 to +90 degrees, material: die-cast aluminium, finish: powder coating in white aluminium according to RAL 9006 | 932141 | 4260491842411 |
|  | angle bracket for wall and corner mounting for mounting the tempLED RayTrack Lite on facades and building corners, made of cylindrical tube Ø 60 mm; inclination 15 degrees; projection 500 mm, material: stainless steel, finish: natural | 932150 | 4260491842008 |
|  | mounting bracket »K« suitable only for tempLED RayTrack Lite 75 / 150 for flexible mounting of the tempLED RayTrack Lite on facades, ceilings and walls, adjustment range: -90 to +90 degrees, material: steel, finish: powder coating in white aluminium according to RAL 9006 | 932142 | 4260491842428 |
|  | mounting bracket »G« suitable only for tempLED RayTrack Lite 240 for flexible mounting of the tempLED RayTrack Lite on facades, ceilings and walls, adjustment range: -90 to +90 degrees, material: steel, finish: powder coating in white aluminium according to RAL 9006 | 932145 | 4260491842459 |
|  | angle bracket one-sided for mast plait Ø 76 mm made of cylindrical tube Ø 60 mm; inclination 15 degrees; projection 500 mm, material: steel, finish: galvanised | 932351 | 4260491842121 |
|  | angle bracket two-sided 90 degrees for mast plait Ø 76 mm made of cylindrical tube Ø 60 mm; inclination 15 degrees; projection 500 mm, material: steel, finish: galvanised | 932016 | 4260745231350 |
|  | angle bracket two-sided 180 degrees for mast plait Ø 76 mm made of cylindrical tube Ø 60 mm; inclination 15 degrees; projection 500 mm, material: steel, finish: galvanised | 932352 | 4260491842138 |
|  | angle bracket three-sided 120 degrees for mast plait Ø 76 mm made of cylindrical tube Ø 60 mm; inclination 15 degrees; projection 500 mm, material: steel, finish: galvanised | 932353 | 4260491842145 |
|  | angle bracket four-sided 90 degrees for mast plait Ø 76 mm made of cylindrical tube Ø 60 mm; inclination 15 degrees; projection 500 mm, material: steel, finish: galvanised | 934038 | 4260491844699 |
|  | supply cable extension ready-to-use 3-pin supply cable extension up to 10 meters | 333903 | 4260491843760 |

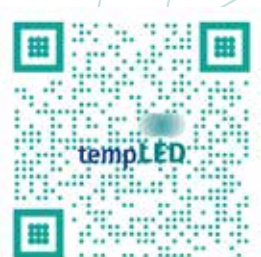

Direct link to the tempLED
download portal



LED is sustainable.
LED is the future.

tempLED luminaires fulfil a recycling rate of > 90%.
That is our product promise to you.

When will you start?